



Emerald House, Croydon, CR0 2NZ

£1,800 PCM



Emerald House, Croydon, CR0 2NZ

£1,800 PCM



The apartment is unusually spacious, featuring two generously sized double bedrooms, each benefiting from excellent natural light and contemporary décor. The principal bedroom enjoys its own en-suite bathroom, while a further three piece bathroom serves the second bedroom. The open plan layout seamlessly combines the kitchen and living areas, creating a versatile space that maximises functionality and openness. The kitchen is finished with high gloss white units and offers ample cupboard space along with integrated appliances, including a dishwasher.

Furnished or unfurnished and decorated in neutral tones throughout, the apartment is ready for immediate occupation.

The property also benefits from one dedicated parking space.

Residents enjoy lift access to all floors, secure bicycle storage, and the added convenience of on-site concierge services. Situated just 0.3 miles from East Croydon Station, the location offers fast rail connections to London Victoria and London Bridge in under 20 minutes, with BOXPARK and the town centre's amenities close by.

Please note that pets are not permitted under the building regulations.

Council Tax Band: E (London Borough of Croydon)
Holding Deposit: £415



Road Map



Hybrid Map



Terrain Map



Floor Plan

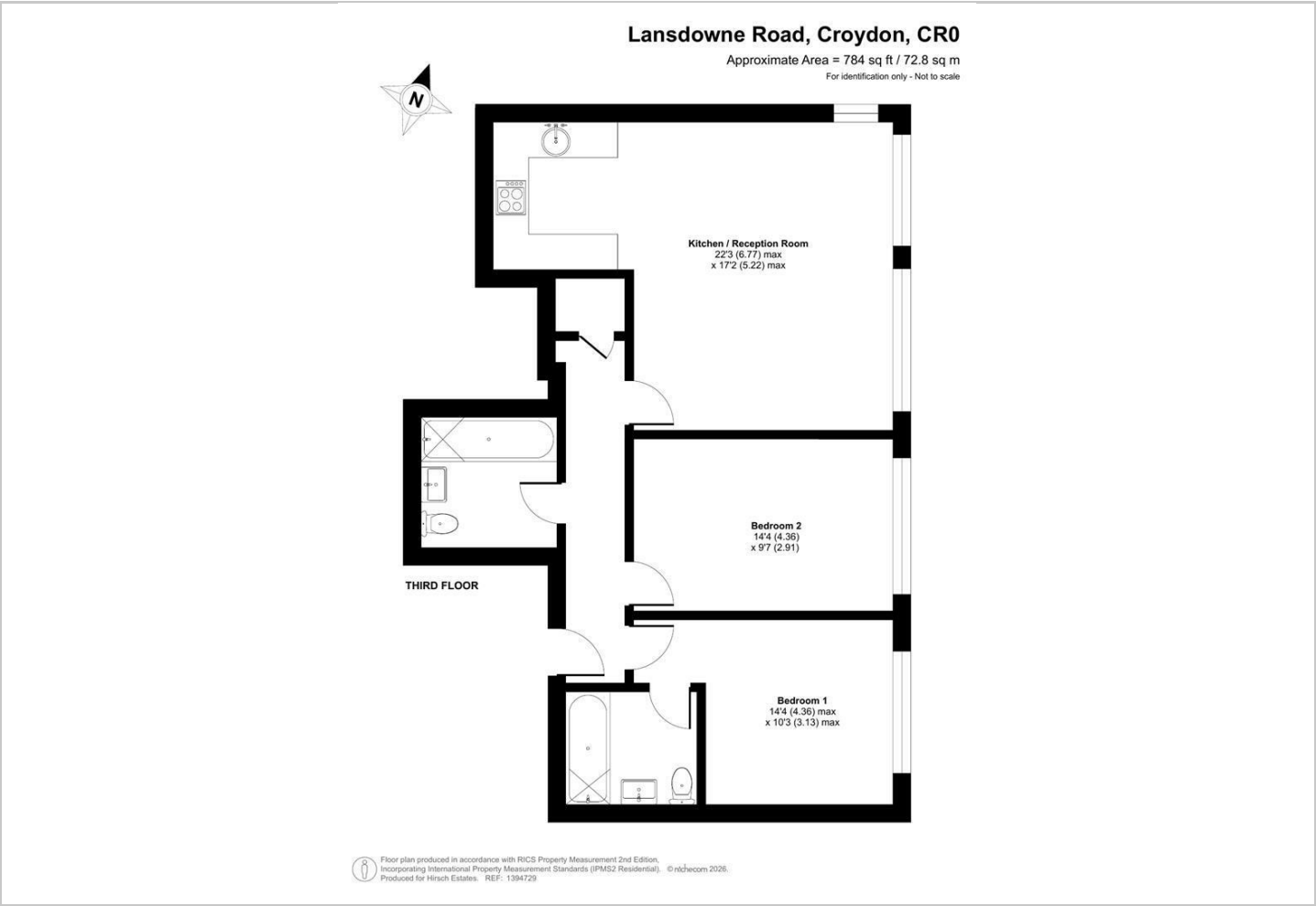

Viewing

Please contact our Hirsch Estates Office on 020 3002 0587 if you wish to arrange a viewing appointment for this property or require further information.

Energy Efficiency Graph

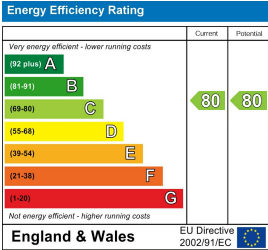

These particulars, whilst believed to be accurate are set out as a general outline only for guidance and do not constitute any part of an offer or contract. Intending purchasers should not rely on them as statements of representation of fact, but must satisfy themselves by inspection or otherwise as to their accuracy. No person in this firms employment has the authority to make or give any representation or warranty in respect of the property.